

# Q-BATTERIES QUALITY

## 12LS-7.2

12V 7,2Ah

VdS G118004, VdS G112003

Design lifetime 5 years



The Q-Batteries LS series are valve regulated and maintenance-free AGM batteries (Absorbent glass mat technology), which have been developed especially for stand-by applications, such as in security technology, fire alarm technology or UPS. The batteries are characterized by excellent energy storage properties and a high level of reliability. The Q-Batteries Akku 12LS-7.2 has a VdS-approval.

### Application:

burglar-systems, UPS-systems,  
fire-detecting-systems,  
telecommunication-systems

### Specification:

Voltage Per Unit	12 V		
Capacity	7,2 Ah (20 h) cell voltage 1.8V / cell		
Cells Per Unit	6		
Weight	ca. 2,5 kg +/- 3%		
Max. Discharge Current	108 A (5 sec.)		
Internal Resistance	ca. 18m $\Omega$		
Operating Temperature Range	Discharge:	Charge:	Storage:
Normal	-15°C - 50°C	0°C ~ 40°C	-15°C ~ 40°C
Operating Temperature Range	25°C $\pm$ 5°C		
Self Discharge	Valve Regulated Lead Acid (VRLA) batteries can be stored at approx. 25°C for up to 6 months. Self-discharge ratio less than 3% per month at 25°C. Please charge batteries before using.		
Terminal	F1, F2		
Technology	AGM, Absorbent glass mat technology		
Container Material	A.B.S. (UL94-HB)		



### Dimensions:

152 Length x 65,5 Width x 94,5 mm (max. 100) Height

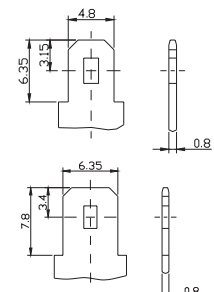
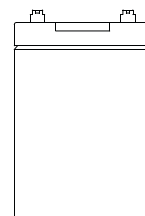
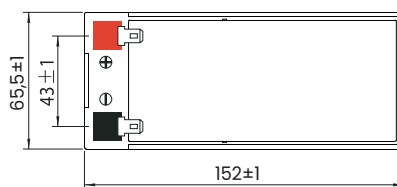
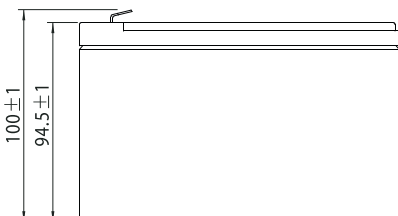

## Constant current discharge characteristics: A (25°C)

F.V/Time	5min	10min	15min	30min	60min	2hr	3hr	4hr	5hr	10hr	20hr
9,6V	166,8	98,4	75	45,96	26,94	15,78	11,58	9,36	7,8	4,308	2,262
9,9V	151,2	91,2	69,6	43,62	25,92	15,36	11,28	9,12	7,62	4,236	2,25
10,2V	137,4	84	64,8	41,46	25,08	14,88	10,98	8,88	7,5	4,182	2,22
10,5V	118,2	75	58,8	38,88	24	14,4	10,74	8,7	7,32	4,116	2,184
10,8V	98,4	65,4	52,8	36,3	22,74	13,8	10,38	8,46	7,14	4,02	2,16

## Constant current discharge characteristics: Watt (25°C)

F.V/Time	5min	10min	15min	30min	60min	2hr	3hr	4hr	5hr	10hr	20hr
9,6V	285	171	132	84	50,7	30	22,08	17,94	15,06	8,466	4,458
9,9V	263,4	160,2	124,8	80,4	49,08	29,4	21,66	17,58	14,82	8,334	4,44
10,2V	242,4	150	117,6	77,4	47,7	28,56	21,18	17,22	14,52	8,25	4,386
10,5V	211,8	136,2	108	72,6	45,9	27,66	20,7	16,86	14,22	8,124	4,308
10,8V	178,2	120	97,8	68,4	43,62	26,64	20,1	16,5	13,92	7,938	4,272

## Storage characteristic:

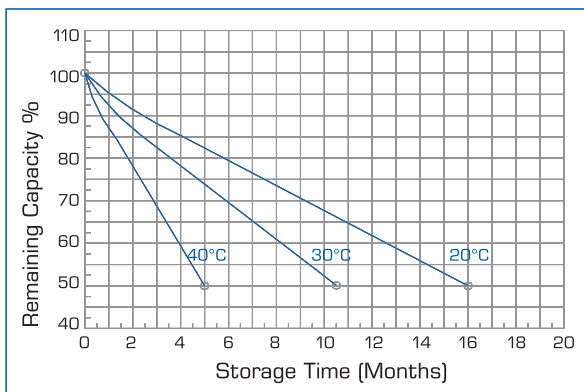

## Charging Method:

Recharge after use, at least every 6th month:

Cyclic charging voltage  
14,4V bis 15V (25°C)

Float charging voltage (25°C)  
13,5V bis 13,8V (25°C)

Maximum charging current  
2,1A

Do not short circuit the battery.

## Capacity Factors with different Temperature:

Battery Type		-20°C	-10°C	0°C	5°C	10°C	20°C	25°C	30°C	40°C	45°C
GEL Battery	6V & 12V	50%	70%	83%	85%	90%	98%	100%	102%	104%	105%
	2V	60%	75%	85%	88%	92%	99%	100%	103%	105%	106%
AGM Battery	6V & 12V	46%	66%	76%	83%	90%	98%	100%	103%	107%	109%
	2V	55%	70%	80%	85%	92%	99%	100%	104%	108%	110%