



12LS-7 F2

12V 7Ah

Design lifetime 5 years

The Q-Batteries LS series are valve regulated and maintenance-free AGM batteries (Absorbent glass mat technology), which have been developed especially for stand-by applications, such as in security technology, fire alarm technology or UPS. The batteries are characterized by excellent energy storage properties and a high level of reliability. The Q-Batteries Akku 12LS-7.2 has a VdS-approval.

Application:

burglar-systems, UPS-systems,
fire-detecting-systems,
telecommunication-systems



Specification:

Voltage Per Unit	12 V		
Capacity	7 Ah (20 h) cell voltage 1.8V / cell		
Cells Per Unit	6		
Weight	ca. 2,35 kg +/- 3%		
Max. Discharge Current	105 A (5 sec.)		
Internal Resistance	ca. 28m Ω		
Operating Temperature Range	Discharge:	Charge:	Storage:
Normal	-15°C – 50°C	0°C ~ 40°C	-15°C ~ 40°C
Operating Temperature Range	25°C \pm 5°C		
Self Discharge	Valve Regulated Lead Acid (VRLA) batteries can be stored at approx. 25°C for up to 6 months. Self-discharge ratio less than 3% per month at 25°C. Please charge batteries before using.		
Terminal	F2		
Technology	AGM, Absorbent glass mat technology		
Container Material	A.B.S. (UL94-HB)		

Dimensions:

152 Length x 65,5 Width x 94,5 mm (max. 100) Height

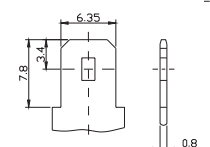
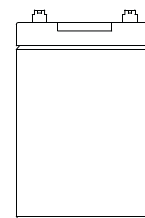
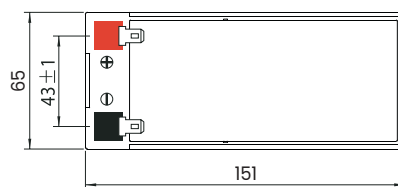
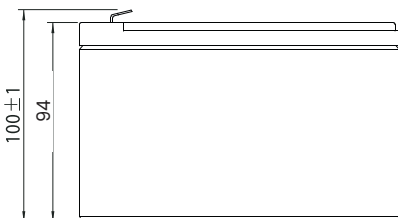

Constant current discharge characteristics: A (25°C)

F.V/Time	5min	10min	15min	30min	60min	2hr	3hr	4hr	5hr	10hr	20hr
9.60V	26.8	16.9	13.4	7.47	4.58	2.50	1.80	1.44	1.22	0.67	0.36
9.90V	26.0	16.4	13.1	7.32	4.51	2.49	1.79	1.43	1.22	0.66	0.36
10.2V	24.9	15.7	12.6	7.10	4.40	2.47	1.77	1.42	1.21	0.66	0.35
10.5V	23.8	15.1	12.2	6.93	4.31	2.43	1.76	1.41	1.20	0.66	0.35
10.8V	22.5	14.2	11.5	6.67	4.18	2.37	1.71	1.37	1.16	0.64	0.35

Constant current discharge characteristics: Watt (25°C)

F.V/Time	5min	10min	15min	30min	60min	2hr	3hr	4hr	5hr	10hr	20hr
9.60V	299	191	153	85.6	53.1	29.3	21.4	17.1	14.6	7.99	4.29
9.90V	290	185	149	83.9	52.3	29.1	21.2	17.0	14.5	7.95	4.28
10.2V	278	177	144	81.4	50.9	28.9	21.1	16.9	14.4	7.92	4.26
10.5V	266	170	139	79.4	49.9	28.4	20.9	16.8	14.3	7.87	4.23
10.8V	251	160	131	76.5	48.4	27.7	20.3	16.3	13.9	7.71	4.15

Storage characteristic:

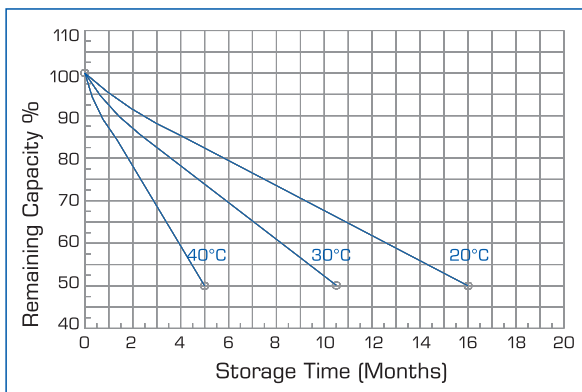

Charging Method:

Recharge after use, at least every 6th month:

Cyclic charging voltage
14,4V bis 15V (25°C)

Float charging voltage (25°C)
13,5V bis 13,8V (25°C)

Maximum charging current
2,1A

Do not short circuit the battery.

Capacity Factors with different Temperature:

Battery Type		-20°C	-10°C	0°C	5°C	10°C	20°C	25°C	30°C	40°C	45°C
GEL Battery	6V & 12V	50%	70%	83%	85%	90%	98%	100%	102%	104%	105%
	2V	60%	75%	85%	88%	92%	99%	100%	103%	105%	106%
AGM Battery	6V & 12V	46%	66%	76%	83%	90%	98%	100%	103%	107%	109%
	2V	55%	70%	80%	85%	92%	99%	100%	104%	108%	110%